



**B-1185/86, Lower Ground Floor,
G.D. Colony Mayur Vihar PH-III,
Delhi-96**



**interact@sohammgroupp.com ,
www.sohammproject.com**



+91-8383052356: +91-9350980673

PRE-FABRICATED BUS SHELTERS CATALOGUE

About Sohamm Project Services

Sohamm Project Services is an urban infrastructure solutions company based in New Delhi, India, focused on rapid-deployment, prefabricated structures for public transport and civic amenities. Our shelters combine robust engineering, modularity, and elegant design—optimized for Indian climates and high footfall corridors

What we offer - End-to-end delivery: design → fabrication → installation → maintenance - PAN-India execution capability with standardized modules - Compliance with IRC, IS codes, and local municipal guidelines - Customization for branding, smart-city features, and accessibility

Signature Models & Specifications



MODEL# SPS-PFBS-001

6m Bus Shelter

Overall size: L6000*W2000*H2400mm

Single sided LED screen lightbox visible size: W960*H1280mm

Hanging single sided LED screen visible size: W500*H250mm

Material:

Structure:: Galvanized pipe

Ceiling: Galvanized Pipe+ Galvanized sheet

Back side: Galvanized sheet,10mm tempered glass

Lightbox: Galvanized sheet+6mm tempered glass

Bench: Galvanized Pipe+ Galvanized Sheet+ Antiseptic wood

Surface finished: powder coated

Wind resistance: 120KM/H

With LED Ceiling Light, LED decorative light Strip, Intelligent monitoring system * 1set (including recorder and hard drive, network cable and camera * 2)

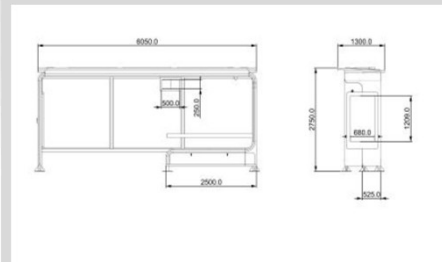

PRICE : INR 22,00,000 (INCL. TAXES)



MODEL# SPS-PFBS-002

6m Bus shelter with Solar system

Overall size: L6000*W1800*H2800mm

(Left)Double sided lightbox Size:W1100*H1600mm

(Back)Single sided lightbox Size:W2300*H1200mm

Material:

Structure: galvanized pipe, galvanized sheet

Roof: galvanized pipe, galvanized sheet, with LED strip light

Back side: 10mm tempered glass with glass film

Lightbox: galvanized sheet+6mm tempered glass+LED light

Bench: galvanized pipe, galvanized sheet

High position backrest: galvanized sheet, antiseptic batten

Surface treatment: powder coated

With LED light * 2 (Without the separated Light box on the right and ceiling LED screen)

PRICE: INR 15,00,000 (INCL TAXES)



MODEL# SPS-PFBS-003

7m Bus shelter (With AC)

Overall size: L7000*W1800*H2800mm

Left single-sided lightbox : W1750*H980mm

Right single- sided light box : W980*H1600mm

Material:

Structure: Galvanized plate+ galvanized pipe

Roof: Galvanized plate+ galvanized pipe+ PC board, aluminum plate, ceiling light

Wall panel : galvanized pipe

Back sided: 10mm tempered glass without silk screen

Bench: Galvanized plate+ galvanized pipe ,plastic wood

Light box: Galvanized plate, 6mm tempered glass without silk screen, LED lights

Cladding plate : Galvanized plate

Poster frame: Galvanized pipe, aluminum profile

Surface finished: powder coated

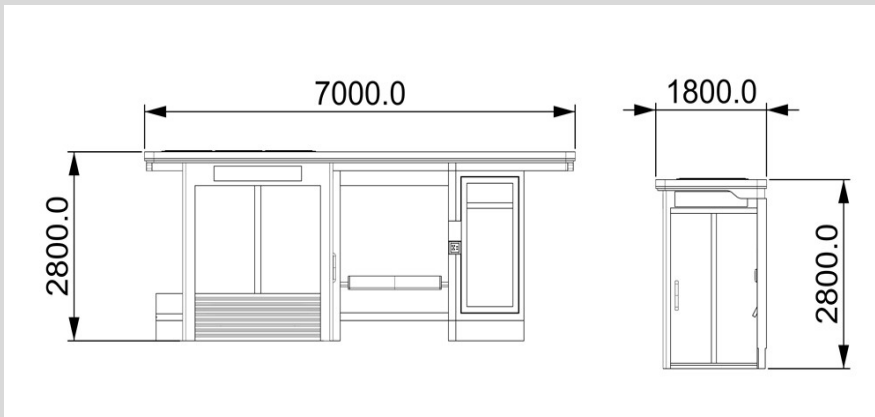

PRICE: INR 26,00,000 (INCL TAXES)

FOR ENQUIRIES CONTACT:

**Ar. Manish Singh
M/S Sohamm Project Services
B-1185/86, Lower Ground Floor,
G.D. Colony Mayur Vihar PH-III, Delhi-96**

E Mail: interact@sohammgroup.com



www.sohammproject.com



+91-9350980673

For RFPs and bulk tenders, we can align to city branding manuals and ad policy guidelines.